

# INTERTON | SCOPE

## USER GUIDE - RIE

S460-D

S460-D Open

S460-D HPG

S660-D

S660-D Open

S660-D HPG

Thank you for selecting an Interton hearing system. We are proud of our hearing products and are confident you have chosen one of the best products available. Please familiarize yourself with the information in this guide. It contains important instructions for proper use and care, technical performance information, and other general information about your hearing system. Your hearing system has been adjusted to your particular hearing loss. Your hearing healthcare professional will explain these adjustments and the special features of your particular model.

### Becoming Accustomed to Amplification

While purchasing a hearing system is a major step, it is only one step in a process toward more comfortable hearing. Successfully adapting to the amplification your hearing system provides takes time and consistent use.

You will enjoy more benefits from your Interton hearing system by taking the following actions:

- Wear the system regularly in order to get comfortable with using it.
- Begin by wearing your system for short periods of time in quiet environments.
- As you get more comfortable with the system, increase the wearing time and wear your hearing system in multiple types of listening environments.

It may take as long as several months for your brain to get used to all the “new” sounds around you. Following these suggestions will give your brain time to learn how to interpret amplification and increase the benefits you get from using an Interton hearing system.

## Contents

Your Hearing System	4	Cleaning the Microphone Sound Inlets	20
On/Off Function	6	Cleaning the Receiver Dome and Tube	21
Power-on Delay	6	Cleaning the Earmould	22
Stand-By Mode	7	Changing the Dome	23
Volume Control	7	Earwax Management	25
Changing Memory Programs	8	When the Hearing System Is Not in Use	25
Dual Microphone System	9	Things that Can Damage	
Proper Placement in the Ear	10	Your Hearing System	26
Using the Telephone	14	Moisture	26
Telecoil	14	Temperature Extremes	26
Cellular Phone and		Rough Treatment	27
Hearing Instrument Compatibility	15	Corrosive Substances	27
Using Assistive Listening Systems	16	General Warnings	28
Removing/Inserting the Battery	17	Solving Small Problems	30
Low Battery Warning	18	General Precautions	34
Battery Safety	19	Hearing Instrument Identification	35
Cleaning the Instrument	20	Repairs	36
		Technical Specifications	36
		Notes	37

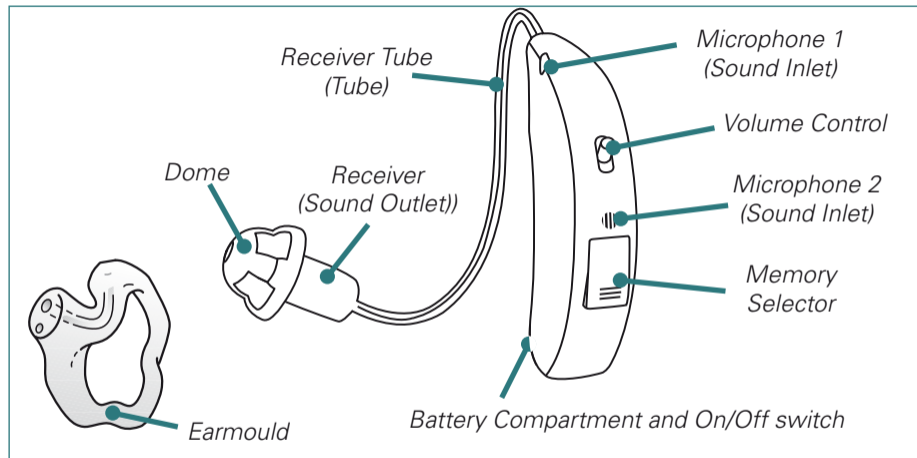

Scope 4/Scope 6 Receiver In-the-Ear (RIE)

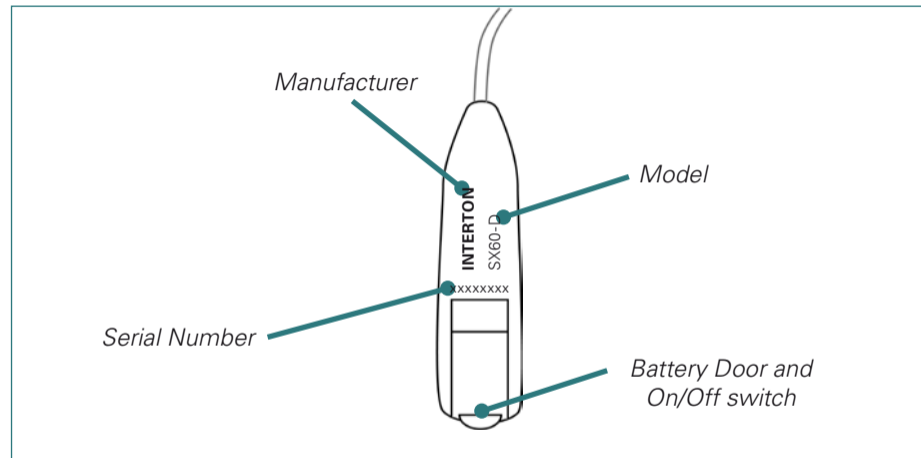

### On/Off Function

The door to the battery compartment serves as the On/Off switch for your hearing instrument. When the door is fully closed, the instrument is on. To turn the instrument off, press the tab on the base of the instrument with your fingertip until the battery door snaps partly open, then put your fingernail under the nail grip and pull gently to open it completely.

**Tip:** To reduce battery consumption, turn the instrument off when it is not in use.

### Power-on delay

Power-on delay allows you to insert the instrument in your ear without the hearing instrument squealing. It delays the switch-on time by 10 seconds after closing the battery compartment. A beep each second is presented during this time.

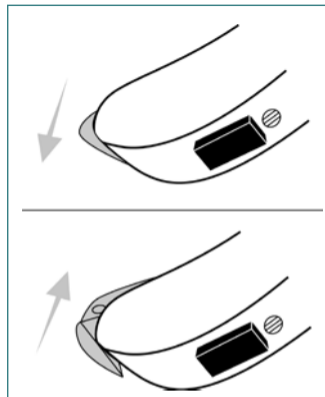

### Stand-By Mode

Stand-by mode reduces battery consumption since only a small amount of power is used. When in stand-by mode, the hearing instrument will not deliver sound to the ear. You can put the instrument into stand-by mode by holding down the Memory Selector for more than one second. You will hear a series of beeps, indicating that the instrument is now in stand-by mode.

To return to functional mode, simply press the Memory Selector once.

### Volume Control

Your hearing system is equipped with a toggle volume control. Simply press the toggle up to increase the volume, or down to decrease the volume.

For each volume step, you will hear a beep signal indicating the change. The loudness of the beeps will increase as you turn the volume up and decrease as you turn it down. If you reach the upper or lower limit of the volume control range, there will be a different type of beep signal with a lower pitch.

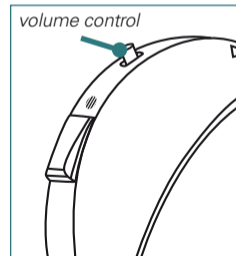

## Changing Memory Programs

Hearing instrument memories are used to store settings optimal in different listening situations. Your hearing healthcare professional may have programmed multiple memories into your hearing instruments to accommodate your lifestyle needs.

For future reference, ask your hearing health professional to fill in your memory program information on the notes page at the back of this guide.

Whenever the hearing instrument is turned on, Memory 1 is automatically activated. Memories can then be selected by pushing the Memory Selector button on the instrument. Your hearing instrument may have up to 4 programs.

Special tones will indicate which memory has been activated. One tone will sound when Memory 1 is activated, two tones will sound when Memory 2 is activated, etc. Memories are always activated in sequence, for example, with three memories: 1 to 2, 2 to 3, 3 to 1. Consult your hearing healthcare professional if the memory programs in your hearing instruments need to be reconfigured.

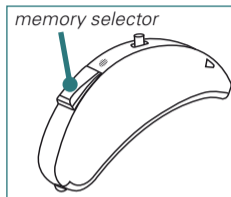

## Dual microphone system

If you want to listen to a person in a noisy environment, the microphones in your hearing instrument can help you to concentrate on the speech. If the microphones are in the directional mode the background noise will be attenuated. In this mode the sounds in front of you will be enhanced, so you can hear better the speech of the person you look at.

Your hearing care practitioner can program the device in the required modes.

Depending on your hearing instrument and the setting chosen by you and your hearing care practitioner switching to and from directional mode can be done automatically.

## Proper Placement in the Ear

### *Inserting the Receiver Dome and RIE Instrument:*

- With the battery door open (the off position), hold your hearing instrument by the tube, right where it bends.
- Hang the instrument over the top of your ear so that the housing portion is behind your ear and the dome is in front.

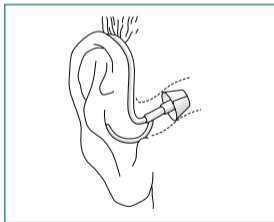
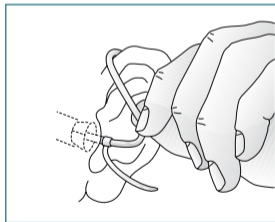
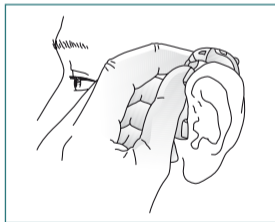

- Push the receiver dome into your ear until it sits comfortably and the tube lies flat against the side of your head. Note: When the receiver dome is placed correctly, you should not see the tube sticking out when looking directly into a mirror.
- If you have not already turned on your hearing instrument, switch it on by closing the battery door.

If you need further help, your hearing healthcare professional will be glad to show you how to insert your hearing instrument correctly.

**Note:** If your hearing instrument irritates your ear in any way and prevents you from wearing your hearing instrument, please contact your hearing healthcare professional. Never attempt to modify the shape of your hearing instrument yourself.

### *Inserting the Standard Earmould and RIE Instrument:*

- With the battery door half open (Off position), put your earmould between your thumb and index finger and position its “point” in your ear canal. Now, slide the earmould all the way into your ear with a gentle, twisting movement.
- Place the hearing instrument behind your ear. Move the earmould up and down and press gently to ensure it is positioned correctly in the ear. You will feel when the earmould is positioned correctly.
- Switch on your hearing aid.

**Tip:** Insertion of the earmould can be easier if you gently pull your ear backward with your other hand. Opening and closing your mouth while inserting may also be helpful.

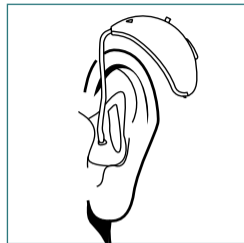

### **Removal**

To remove the hearing instrument from your ear, simply pull the tube outward with your thumb and forefinger. Consult your hearing healthcare professional if you have difficulty removing the hearing instrument.

### Using the Telephone While Wearing your Hearing System

Close proximity to a telephone can sometimes cause hearing instruments to make a squealing sound, also known as feedback. To reduce the potential for this problem, your system is equipped with a feedback management system, which greatly reduces the chance of feedback. Further measures to avoid feedback include positioning the phone close to the hearing instrument, but not directly on the instrument. If there is feedback, it may take a few seconds for the instrument's signal processing to adapt. This technique may require practice.



### The Telecoil Feature

Your hearing system has a built-in telecoil, and your hearing healthcare professional may have programmed one of your listening programs to take advantage of it. When a telecoil is activated, the hearing instrument will only detect and process sounds coming from the telephone.

To activate the telecoil you will need to use the memory selector to activate the appropriate memory.

To use the telephone while the telecoil is activated, position the telephone near, but not directly on the instrument. You may need to re-position to find the best reception.

### Cellular Phone and Hearing Instrument Compatibility

Hearing instrument performance with cellular phones may vary based on the individual hearing system or the cell phone being used. If your hearing system and cell phone are not compatible you may experience a buzzing or clicking noise while using the two in conjunction. If this is the case with your current hearing system and cell phone, consult with your hearing healthcare professional to see if there are options to improve the sound quality.

#### Measures you can take to prevent this situation:

- When purchasing a hearing system, be sure to test it with your existing phone to determine compatibility.
- When shopping for a new cell phone, be sure to test it with your hearing system before purchasing.

For additional guidance, please consult your cell phone provider.

## Using Assistive Listening (Tele-Loop) Systems

Many gathering places are equipped with assistive listening (tele-loop) systems, for example, in schools, theaters and houses of worship. To take advantage of a tele-loop system, select the telecoil program. When the telecoil program has been selected, you will be able to hear a clean sound signal via the tele-loop system. If the instrument goes dead in the telecoil program, this may be because the loop system is not operating.

If a school, theater or house of worship does not have a tele-loop system, try and sit as close as possible to the front and use one of the microphone programs.

## Removing/Inserting the Battery

Open the battery compartment completely by pressing the tab on the base of the instrument with your fingertip until the battery door snaps partly open, then put your fingernail under the nail grip and pull gently to open it completely. Remove the used battery from the battery compartment.

**Tip:** Hold the instrument over a table or a soft surface in case the battery falls out.

Remove the film from a new battery and place the new battery into the battery compartment, matching the plus (+) sign on flat side of the battery to the plus sign in the battery compartment. A magnifying glass and good lighting may be helpful in seeing these small markings.

The correct battery size for your RIE instruments is a 10A. For future reference, enter this information on the note page at the back of this guide.

Close the battery compartment tightly but do not use force - it should close very easily. Your hearing system should now be on.

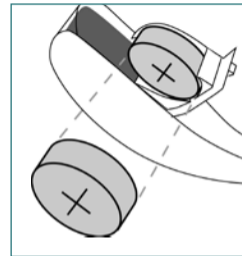

**Tip:** Removing the battery when the instrument is not being worn will help prevent corrosion of the battery contacts. Corrosion can decrease efficiency, causing excessive battery consumption.

**Note:** A weak battery will cause reduced system performance.

### **Low Battery Warning**

Your hearing system features a Low Battery Warning function to give you notice when your battery is getting low.

The instrument will signal when the battery power decreases to a certain level, and will continue beeping until the instrument automatically switches off.

**Tip:** It is helpful to keep spare batteries with you in case you need them.

### **Battery Safety**

- Dispose of used batteries properly.
- Keep batteries out of reach of children or persons with diminished mental capacity.
- Keep batteries away from pets.
- Do not place batteries in your mouth. If a battery has been swallowed, consult a physician immediately.

### **To prevent batteries from leaking or exploding:**

- Do not expose batteries to temperature extremes.
- Do not dispose of batteries in fire.
- Do not attempt to recharge batteries which are not specifically designated rechargeable, or reverse a battery's polarity.

### Cleaning the Instrument

The surfaces of your instruments should be cleaned after every use. Use a soft cloth to remove dirt, dust, earwax and residue from cosmetics or colognes. Keeping the instruments as clean as possible will help avoid costly repairs.

Only use cleaning products recommended by your hearing healthcare professional. Please refer to “Things that Can Damage Your Hearing System” for more information.

### Cleaning the Microphone Sound Inlets

Refer to the diagrams on page 4 to locate the sound inlets on the hearing instrument.

Keeping the sound inlets clean will allow the microphones to function properly. Use the soft brush provided with your hearing instruments to remove dust or other debris from the sound inlets.



### Cleaning the Receiver Dome and Tube

If you have a receiver dome and tube, they should be cleaned regularly.

Use a damp cloth to clean the receiver dome and tube on the outsides. If you notice excessive earwax build-up, please contact your hearing healthcare professional. Improper cleaning may result in damage to your hearing instrument.

Do not submerge or rinse the receiver dome and tube with water, as this would be harmful to the instrument’s electronics.

Please contact your hearing healthcare professional to change the tube if it becomes stiff or brittle.

**Note:** Your hearing instruments have been equipped with filters. For more information, please refer to the “Earwax Management” section.

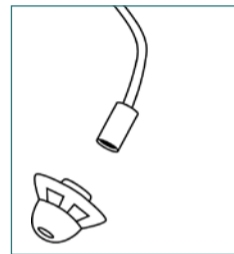

### Cleaning the Earmould (if applicable)

First, remove the earmould from the receiver unit. Use luke-warm water to clean the earwax off the earmould (Never clean the receiver unit with water!) If earwax is stuck in the sound canal of the earmould, the cleaning loop or a syringe with luke-warm water can easily be used to “push” the earwax out.

Be sure to thoroughly dry the earmould before reconnecting it to the hearing aid. Blow gently through it to remove moisture trapped inside.

The receiver unit should be changed by your hearing healthcare professional if the tube becomes stiff or brittle.

**Note:** Your hearing instruments have been equipped with filters. For more information, please refer to the “Earwax Management” section.

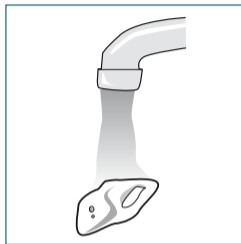

### Changing the Dome

We recommend that you have your hearing healthcare professional change the dome for you if it becomes stiff or brittle. If he or she instructs you to change the dome yourself, make sure that it is securely fastened to the receiver before inserting it into your ear. A failure to change the dome in accordance with the instructions that follow could result in injury.

#### *How to Mount a Dome (Open Dome or Tulip-Dome)*

A dome is mounted by pushing it over the end of the receiver tube. Be sure to push the dome down onto the receiver as much as possible to ensure that it stays on the receiver.

**Note:** If you experience difficulties with mounting of the Dome, consult your hearing healthcare professional.

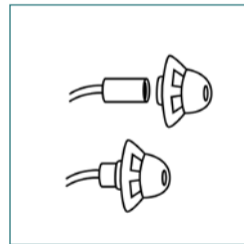

### Preparing a Tulip-Dome for Insertion

The Tulip-Dome must be correctly configured before insertion. The Tulip-Dome consists of two “leaves” and it is important that the largest “leaf” is the outermost “leaf” (figure 3).

This can easily be done by pushing the “leaves” away from the Tube with your finger (figure 1). This will make the large “leaf” bend forward. Then you push it back and it will be placed on top of the smaller “leaf” (figure 2). Now the Tulip-Dome is ready for insertion (figure 3).

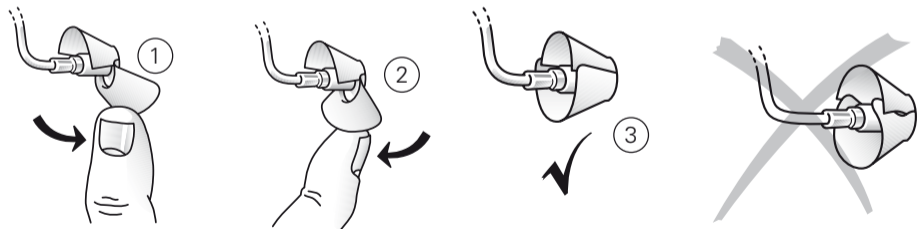

### Earwax Management

Hearing systems are susceptible to damage or poor performance from earwax. If appropriate, your hearing health professional will have selected and installed an earwax management system on your instruments.

You will need to discuss with your hearing healthcare professional how to use the particular earwax management system selected. For future reference, enter this information on the service page at the back of this guide.

**Note:** If the hearing system seems to have lost power because it is not loud enough and changing the batteries does not help, the filters may be blocked and need to be changed.

### When the Hearing System Is Not in Use

To protect your hearing system when it is not in use, always store it inside its carrying case. When storing the hearing system for a prolonged period of time, remove the battery to prevent damage from corrosion.

## Things that Can Damage Your Hearing System

Keep in mind that some of your day-to-day routines require that you remove your hearing system.

### Moisture

Avoid getting moisture in the hearing system. It should not be worn in the shower, bath, or sauna. Do not submerge the instrument in water or other liquids.

If perspiration or humidity is an issue, you may find it beneficial to use a drying kit specially designed for hearing systems. To prevent damage, only use drying kits that are approved by your hearing healthcare professional.

### Temperature Extremes

Do not expose your hearing system to extremes of heat.

Some typical situations to avoid:

- Do not wear your hearing system when using a hair dryer.
- Do not leave your hearing system in your car or in direct sunlight.
- Do not attempt to dry your hearing system in any device other than an approved drying kit.

## Rough Treatment

Protect your hearing system from rough treatment by storing it in the provided carrying case when it is not in use.

### Corrosive Substances

- Non-Approved Cleaning Solutions - If you use cleaning products, only use those recommended by your hearing healthcare professional, as housing can be damaged by certain cleaning agents such as mineral acids, hydrocarbons (benzol), esters, alcohols and ketones.
- Debris from Daily Hygiene Routines - It is suggested you not wear your hearing system while applying the following: hairspray, cosmetics, colognes, perfumes, sunscreens, insect repellent, etc.

## General Warnings

Hearing instruments can be dangerous if improperly used.

- Do not leave your instrument in the sun, near an open fire or in a hot, parked car.
- Do not wear your instrument while showering, swimming, in heavy rain or in a moist atmosphere such as steam bath or sauna.
- Should your instrument become moist, put it in a dessicator. Your hearing care professional will be happy to counsel on this.
- Remove your instrument when applying cosmetics, e.g. perfume, aftershave, hair spray, suntan lotion.
- Instruments should be used only as prescribed by your hearing care professional. Incorrect use may result in sudden and permanent hearing loss.
- Do not allow others to use your instrument. It may cause permanent damage.
- Instrument usage by children or mentally challenged persons should be supervised at any time.

- Do not take your instrument into rooms where you receive treatment with X-rays or MRI.
- Wearing an instrument might cause an increased production of earwax. In rare cases, the anti-allergenic materials may cause skin irritation. If so, or if in doubt, consult your physician or ENT.

## Solving small problems

Your Interton instrument is a reliable one. In case of minor problems or malfunctions, you may be able to solve them yourself.

SYMPTOM	CAUSE	POSSIBLE REMEDY
Feedback, 'whistling'	<ul style="list-style-type: none"><li>• Is the Dome or the Earmould inserted correctly?</li><li>• Is the volume very loud?</li><li>• Are you holding your hand or an object (e.g. a hat) too close to an instrument?</li><li>• Is your ear full of wax?</li></ul>	<ul style="list-style-type: none"><li>• Put it in again</li><li>• Reduce it</li><li>• Move your hand away or create some more space between the instrument and the object</li><li>• Visit your physician</li></ul>
No sound	<ul style="list-style-type: none"><li>• Is the instrument switched on?</li><li>• Is the instrument switched on the telecoil program?</li><li>• Is there a battery in the instrument?</li><li>• Is the battery still good?</li><li>• Is your ear full of wax?</li></ul>	<ul style="list-style-type: none"><li>• Switch it on</li><li>• Switch it to the microphone program</li><li>• Insert a battery</li><li>• Replace it with a new one</li><li>• Visit your physician</li></ul>

## SYMPTOM

## CAUSE

## POSSIBLE REMEDY

Sound is distorted,  
spluttering or weak

- Is the battery dead?
- Is the battery dirty?
- Did your instrument get moist?

- Replace it with a new one
- Clean it or use a new one
- Use a dissector

Battery drains  
very quickly

- Did you leave your hearing instrument switched on at night?
- Is the battery old?

- Always switch off the instrument at night
- Check the date on the battery packaging

### General Precautions

- Consult a physician if you find a foreign object in your ear canal, if you experience skin irritation or if excessive ear wax accumulates with the use of the instrument.
- Different types of radiation, e.g. from NMR or CT scanners, may damage the instrument. Therefore, do not wear the instrument during these or other corresponding scanning procedures. Other types of radiation (burglary alarms, room surveillance systems, radio equipment, mobile telephones, etc) will not damage the instrument. They could, however, momentarily affect the sound quality or create strange sounds from the instruments.
- Warning: Do not wear the instrument in mines or other explosive areas, unless those areas are certified for hearing instrument use.
- Keep the instrument away from children under the age of 3 as it contains small parts which may present a choking hazard.

### Hearing instrument identification

Your hearing care professional place a check mark in the below table to identify the model you have received.

#### Model received

#### Hearing care professional

<input type="checkbox"/> S460-D	<input type="checkbox"/> S660-D	_____
<input type="checkbox"/> S460-D Open	<input type="checkbox"/> S660-D Open	_____
<input type="checkbox"/> S460-D HPG	<input type="checkbox"/> S660-D HPG	_____

Serial number Right: \_\_\_\_\_

Serial number Left: \_\_\_\_\_

## Repairs

If your Interton hearing instrument malfunctions, it must be repaired by a qualified technician. Do not attempt to open the case of the hearing instrument since this would invalidate the warranty. If your Interton hearing instrument requires service, please contact your hearing care professional for assistance.

## Technical Specifications

Max. Output dB SPL according to IEC-118-7

S460-D (RIE)	116 dB SPL
--------------	------------

S460-D Open (RIE Open)	114 dB SPL
------------------------	------------

S460-D HPG (RIE Power)	120 dB SPL
------------------------	------------

S660-D (RIE)	116 dB SPL
--------------	------------

S660-D Open (RIE Open)	114 dB SPL
------------------------	------------

S660-D HPG (RIE Power)	120 dB SPL
------------------------	------------

## Notes:

---

---

---

---

---

---

---

---

---

---

**Notes:**

---

---

---

---

---

---

---

---

---

---

**Notes:**

---

---

---

---

---



Please ask your local hearing care professional concerning disposal of your hearing instrument



*Any issues relating to the EU Medical Device Directive 93/42/EEC should be directed to Interton A/S.*

**CE**  
0297

Interton AS | Lautrupbjerg 7 | DK-2750 Ballerup  
Tel: +45 4575 1111 | [www.interton.com](http://www.interton.com)

17334100-GB.09.12. Rev. A